

WBS NO: 2026CPT.01.03.10661, ETC.

CONTRACT: DA00654

STATE OF NORTH CAROLINA DIVISION OF HIGHWAYS

NORTHAMPTON

STATE	STATE PROJECT REFERENCE NUMBER	SHEET NO.
NC	2026CPT.01.03.10661, ETC.	1
STATE PROJECT NUMBER		DESCRIPTION
2026CPT.01.03.10661, ETC.		P.E., CONST.

TYPE OF WORK: RESURFACING, THIN-LIFT RESURFACING, SHOULDER RECONSTRUCTION, & PAVEMENT MARKINGS

MAP	ROUTE	FROM	TO
01	NC 35	SR 1341 (Deberrys Mill Rd.)	SR 1337 (Britton Rd.)
02	NC 35	SR 1337 (Britton Rd.)	Mill St
03	SR 1109 (Bryantown Rd.)	SR 1108 (Chapel Hill Church Rd.)	US 258
04	SR 1113 (Ash Town Rd.)	SR 1109 (Bryantown Rd.)	Dead End
05	SR 1114 (Ash Town Rd.)	SR 1113 (Ash Town Rd.)	Dead End
06	SR 1504 (Creeksville Rd.)	SR 1501 (Dusty Hill Rd.)	SR 1500 (Zion Church Rd.)
07	SR 1522 (Eagletown Rd.)	NC 305	US 258
08	SR 1523 (Joe Brown Rd.)	SR 1522-Eagletown Rd.	US 258

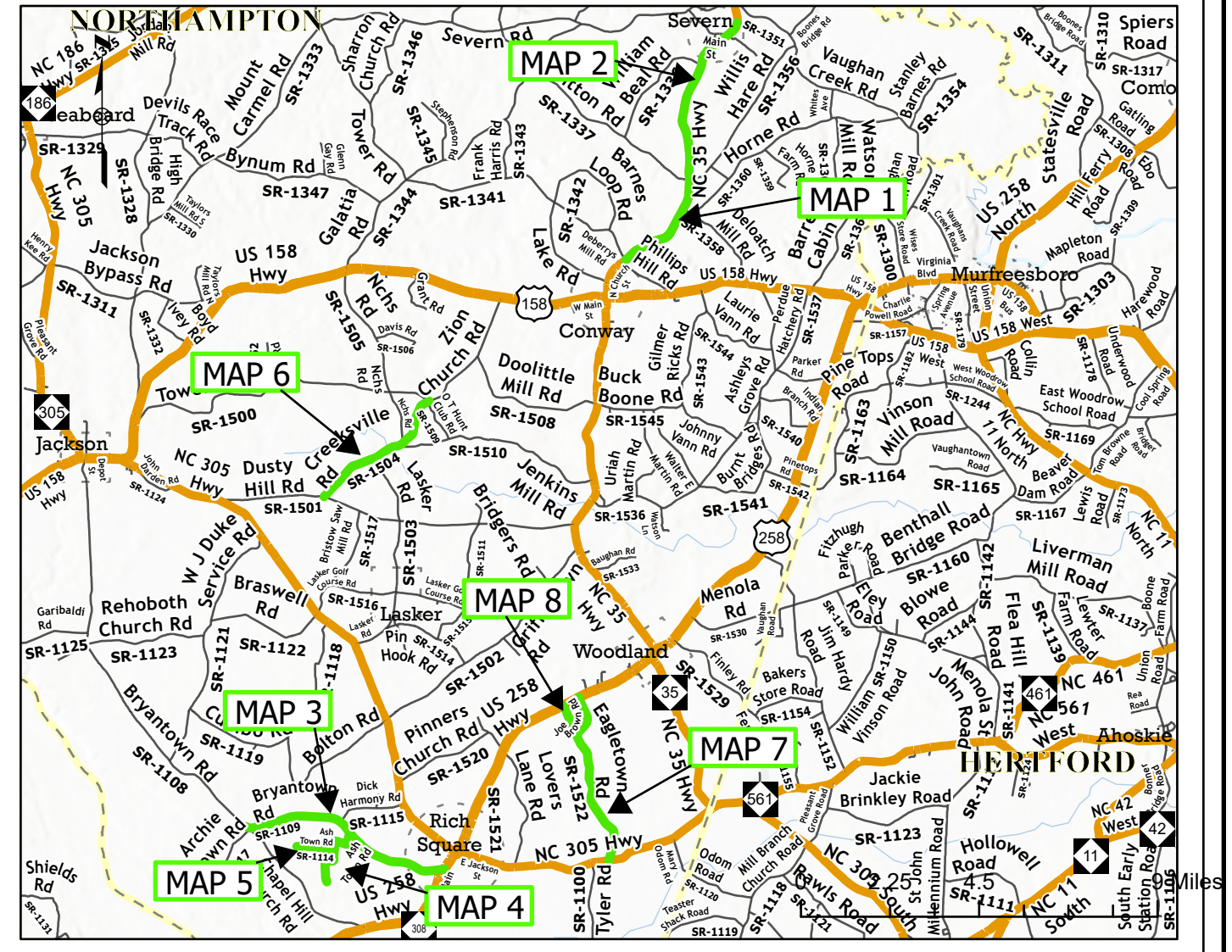

PROJECT LENGTH

MAP	MILES	MAP	MILES
01	2.24	05	0.77
02	3.609	06	3.05
03	4.44	07	3.471
04	1.49	08	0.872

Prepared in the Office of:
DIVISION OF HIGHWAYS
113 AIRPORT DR., EDENTON, NC 27932

B. N. BRASWELL, PE
DIV. PROJ. DEVELOPMENT ENGINEER

M. S. WINSLOW
DIVISION CONTRACT ENGINEER

D. J. CLODGO, PE, PMP
DIVISION PROJECT TEAM LEAD

D. H. STALLINGS
DIVISION DESIGN ENGINEER



PAVEMENT SCHEDULE

C1	PROP. APPROX. 1.5" ASPHALT CONCRETE SURFACE COURSE, TYPE S9.5C, AT AN AVERAGE RATE OF 165 LBS. PER SQ. YD.
U	EXISTING PAVEMENT
V1	INCIDENTAL MILLING
V2	MILLING ASPHALT PAVEMENT, 1.5" DEPTH

NOTES:

- * ALL INTERSECTING ROADS ARE TO BE RESURFACED TO THE ENDS OF THEIR RADII, THE MAIN LINE RIGHT OF WAY OR AS DIRECTED BY THE ENGINEER. THIS SHALL INCLUDE ANY TAPERS AND TURN LANES LOCATED BOTH ON THE MAIN LINE OR INTERSECTING PAVED ROADWAY.
- * EDGES, PAVEMENT WIDENING, INTERSECTIONS AND BRIDGE FLARES ARE INCLUDED IN THE SUMMARY OF QUANTITIES.
- * 1.5" OF S9.5C TO BE APPLIED THE FULL WIDTH OF THE ROADWAY
- * CONTRACTOR SHALL PERFORM PATCHING EXISTING PAVEMENT, FULL DEPTH BEFORE APPLICATION OF 1.5" OF S9.5C

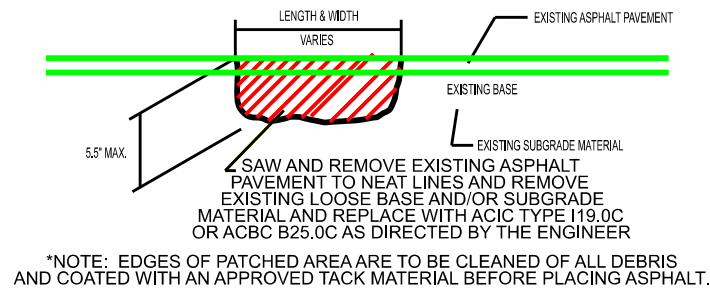

PATCHING EXISTING PAVEMENT (FULL DEPTH)

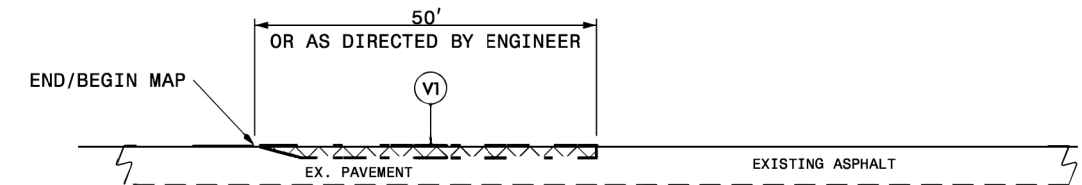

**DETAIL 1
MAIN LINE MILLING**

- NOTE:
1. INCLUDES INCIDENTAL MILLING AT THE ENDS OF MAIN LINE SECTIONS, OR AS DIRECTED BY THE ENGINEER.
 2. PAVE TO THE END OF THE MILLED SURFACE TO CREATE A SMOOTH TRANSITION.

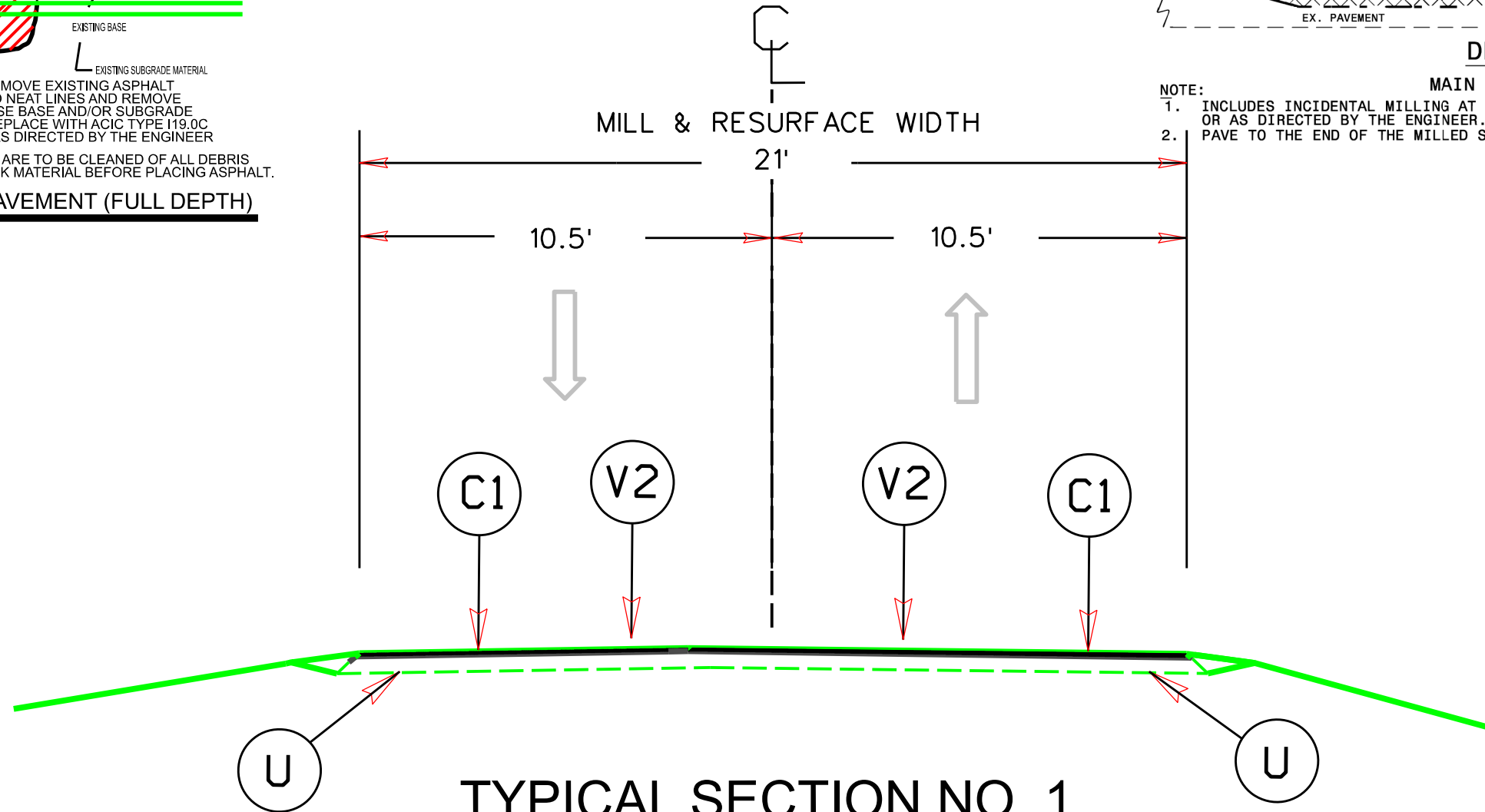

TYPICAL SECTION NO. 1

USE WITH MAP 1 & 2

SYSTEMS DESIGN

PAVEMENT SCHEDULE

C2	PROP. APPROX. 1.5" ASPHALT CONCRETE SURFACE COURSE, TYPE S9.5B, AT AN AVERAGE RATE OF 165 LBS. PER SQ. YD.
U	EXISTING PAVEMENT
T	SHOULDER RECONSTRUCTION
V1	INCIDENTAL MILLING

NOTES:

- * ALL INTERSECTING ROADS ARE TO BE RESURFACED TO THE ENDS OF THEIR RADII, THE MAIN LINE RIGHT OF WAY OR AS DIRECTED BY THE ENGINEER. THIS SHALL INCLUDE ANY TAPERS AND TURN LANES LOCATED BOTH ON THE MAIN LINE OR INTERSECTING PAVED ROADWAY.
- * EDGES, PAVEMENT WIDENING, INTERSECTIONS AND BRIDGE FLARES ARE INCLUDED IN THE SUMMARY OF QUANTITIES.
- * 1.5" OF S9.5B TO BE APPLIED THE FULL WIDTH OF THE ROADWAY
- * CONTRACTOR SHALL PERFORM PATCHING EXISTING PAVEMENT, FULL DEPTH BEFORE APPLICATION OF 1.5" OF S9.5B

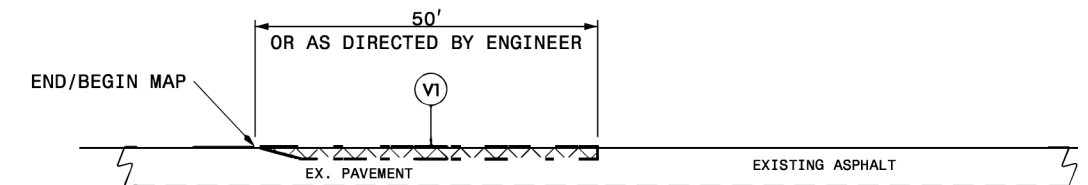
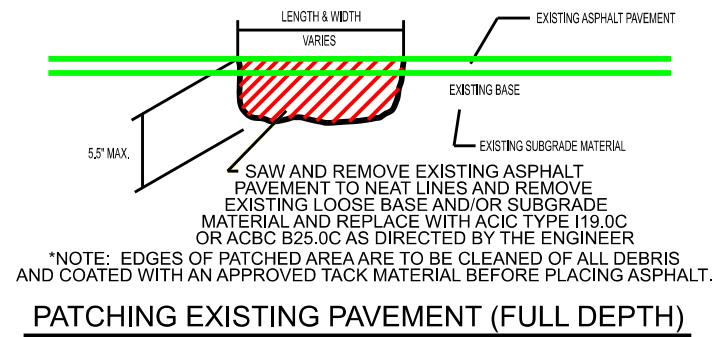

DETAIL 1
MAIN LINE MILLING

NOTE:
1. INCLUDES INCIDENTAL MILLING AT THE ENDS OF MAIN LINE SECTIONS, OR AS DIRECTED BY THE ENGINEER.
2. PAVE TO THE END OF THE MILLED SURFACE TO CREATE A SMOOTH TRANSITION.

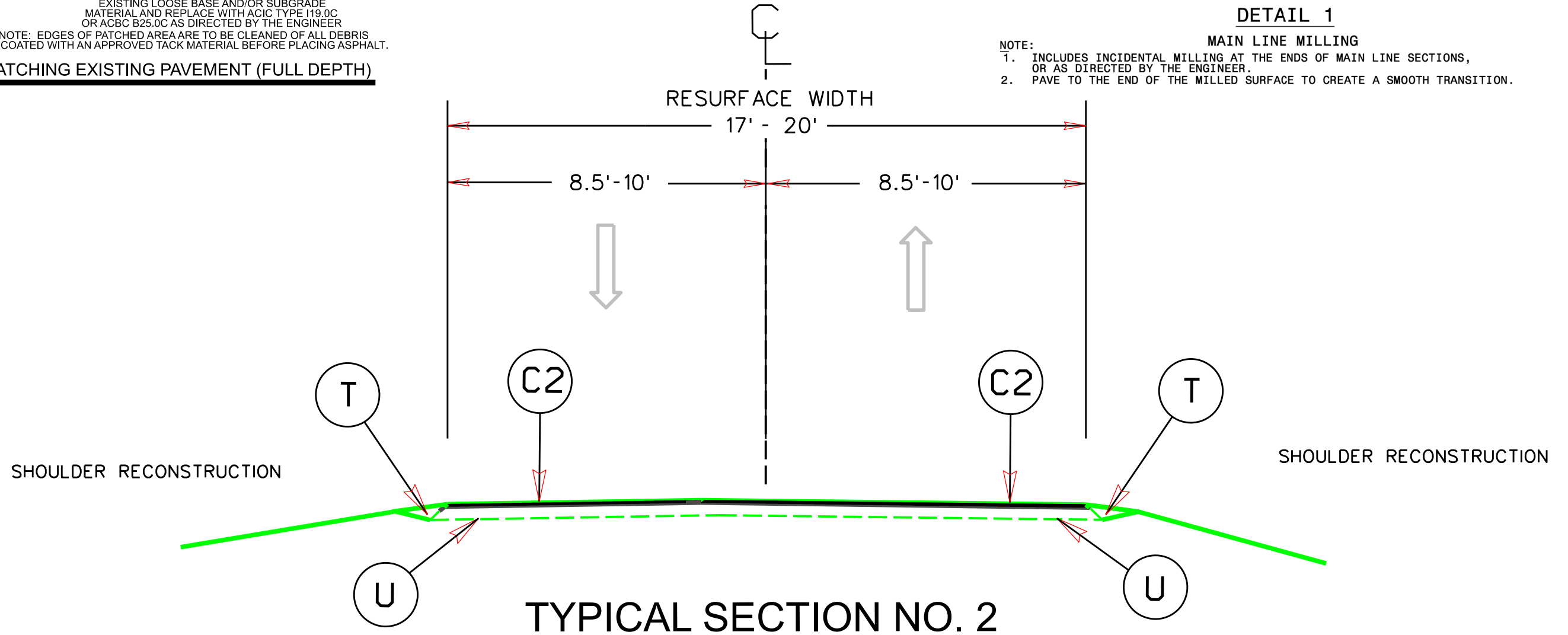

TYPICAL SECTION NO. 2

USE WITH MAPS 3 - 8

SYSTEMS DESIGN

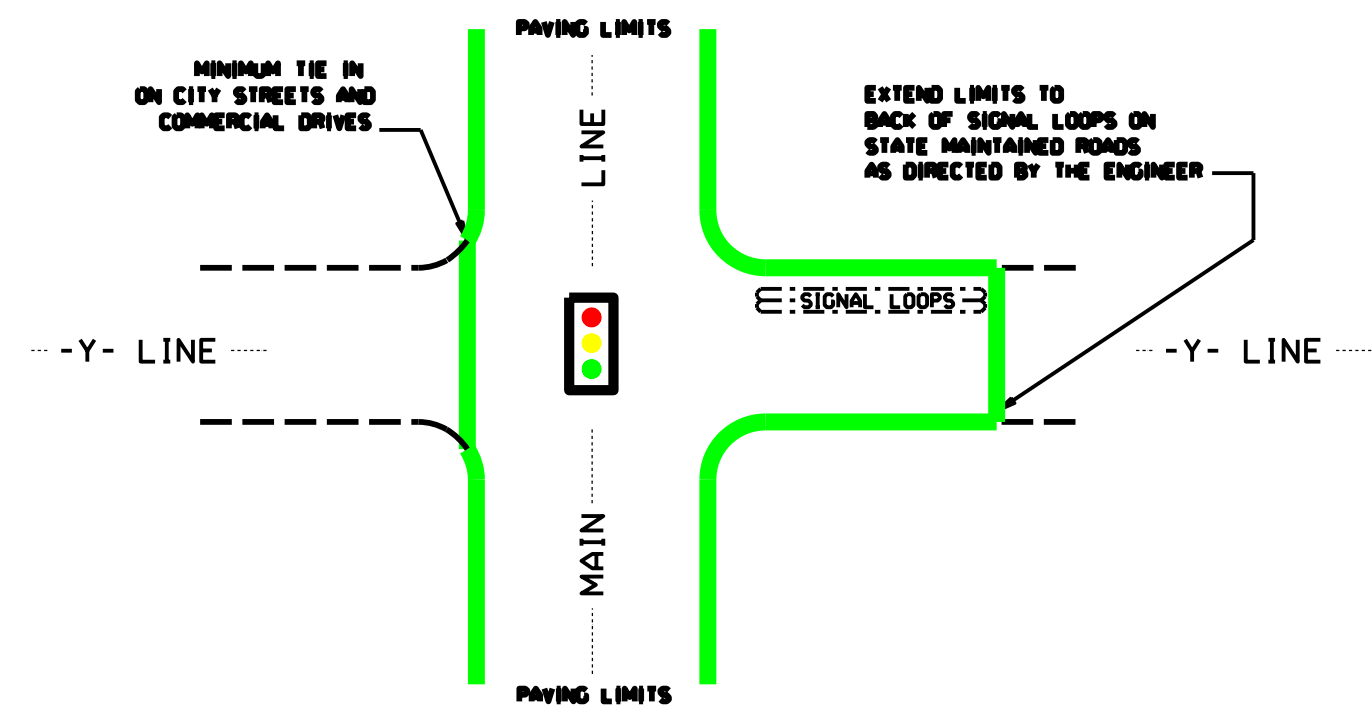

TYPICAL DETAIL OF PROJECT LIMITS AT SIGNALIZED Y LINES

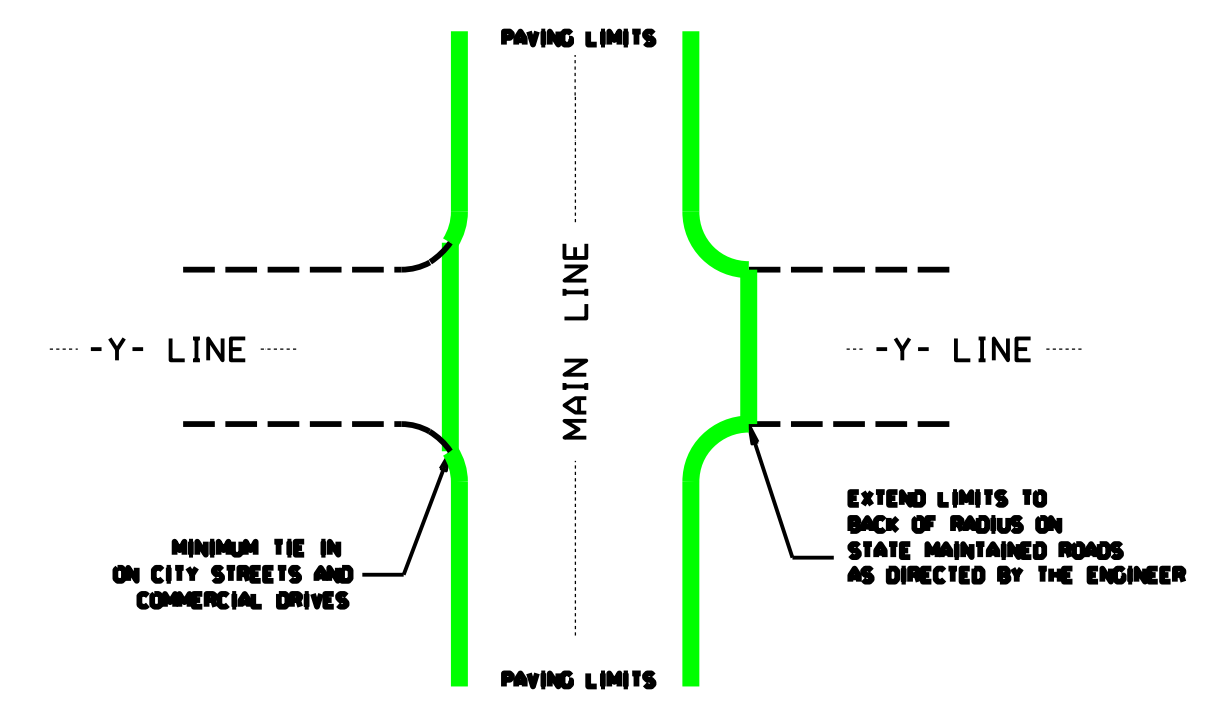

TYPICAL DETAIL OF PROJECT LIMITS AT UNSIGNALIZED Y LINES

ADDITIONAL INTERSECTIONS (NON-TYPICAL)		
Extend paving limits to back of radius or loop on the following intersections:		
MAP#	STREET NAME	COMMENTS

PAVE ALL STATE OWNED & TOWN STREETS TO BACK OF RADIUS FOR THIS PROJECT

PROJECT NO.	SHEET NO.	TOTAL NO.
2026CPT.01.03.10661, ETC.	5	

SUMMARY OF QUANTITIES

PROJECT NO	COUNTY	MAP NO	ROUTE	DESCRIPTION	TYP NO	LANES	LANE TYPE	LENGTH	WIDTH	BEGIN MP	END MP	000100000-N	010600000-E	122000000-E	124500000-E	129700000-E	133000000-E	151900000-E	152000000-E	152300000-E	157500000-E			
												MOBILIZATION	BORROW EXCAVATION	INCIDENTAL STONE BASE	SHOULDER RECONSTRUCTION	MILLING ASPHALT PAVEMENT (1 1/2")	INCIDENTAL MILLING	ASPHALT CONC SURFACE COURSE, S9.5B	ASPHALT CONC LEVELING COURSE, S9.5B	ASPHALT CONC SURFACE COURSE, S9.5C	ASPHALT BINDER FOR PLANT MIX			
												LS	CY	TONS	SMI	SY	SY	TONS	TONS	TONS	TONS			
2026CPT.01.03.10661	Northampton	1	NC-35 N / NC 35 HWY	FROM SR 1341 (DEBERRYS MILL RD.) TO SR 1337 (BRITTON RD.)	1	2	2WU	2.24	21	12.436	14.676	1				27,597	1,126			2,576	152			
TOTAL FOR MAP NO. 1								2.24								27,597	1,126			2,576	152			
2026CPT.01.03.10661	Northampton	2	NC-35 N / NC 35 HWY	FROM SR 1337 (BRITTON RD.) TO MILL ST	1	2	2WU	3.609	21	14.676	18.285	*				44,463	1,471			4,133	244			
TOTAL FOR MAP NO. 2								3.609								44,463	1,471			4,133	244			
TOTAL FOR PROJ NO. 2026CPT.01.03.10661								5.849									72,060	2,597			6,709	396		
2026CPT.01.03.20661	Northampton	3	SR-1109 / BRYANTOWN RD	FROM SR 1108 (CHAPEL HILL CHURCH RD.) TO US 258	2	2	2WU	4.44	20	0	4.44	*	799	70	8.88			4,856			317			
TOTAL FOR MAP NO. 3								4.44							799	70	8.88			4,856		317		
2026CPT.01.03.20661	Northampton	4	SR-1113 / ASH TOWN RD	FROM SR 1109 (BRYANTOWN RD.) TO DEAD END	2	2	2WU	1.49	19	0	1.49	*	268	10	2.98			1,517			101			
TOTAL FOR MAP NO. 4								1.49							268	10	2.98			1,517		101		
2026CPT.01.03.20661	Northampton	5	SR-1114 / ASH TOWN RD	FROM SR 1113 (ASH TOWN RD.) TO DEAD END	2	2	2WU	0.77	18	0	0.77	*	139	13	1.54			743			49			
TOTAL FOR MAP NO. 5								0.77							139	13	1.54			743		49		
2026CPT.01.03.20661	Northampton	6	SR-1504 / CREEKSVILLE RD	FROM SR 1501 (DUSTY HILL RD.) TO SR 1500 (ZION CHURCH RD.)	2	2	2WU	3.05	18	0	3.05	*	549	36	6.10		421	3,072			200			
TOTAL FOR MAP NO. 6								3.05							549	36	6.10		421	3,072		200		
2026CPT.01.03.20661	Northampton	7	SR-1522 / EAGLETOWN RD	FROM NC 305 TO US 258	2	2	2WU	3.471	17	0	3.471	*	625	35	6.94		95	3,165	15		209			
TOTAL FOR MAP NO. 7								3.471							625	35	6.94		95	3,165	15	209		
2026CPT.01.03.20661	Northampton	8	SR-1523 / JOE BROWN RD	FROM SR 1522-EAGLETOWN RD. TO US 258	2	2	2WU	0.872	19	0	0.872	*	157	10	1.74			888	5		58			
TOTAL FOR MAP NO. 8								0.872							157	10	1.74			888	5	58		
TOTAL FOR PROJ NO. 2026CPT.01.03.20661								14.093							2,537	174	28.18		516	14,241	20	934		
GRAND TOTAL								19.942						1	2,537	174	28.18		72,060	3,113	14,241	20	6,709	1,330

SUMMARY OF QUANTITIES

PROJECT NO	COUNTY	MAP NO	ROUTE	DESCRIPTION	TYP NO	LANES	LANE TYPE	LENGTH	WIDTH	BEGIN MP	END MP	170500000-E	283000000-N	303000000-E	328700000-N	331900000-N	336000000-E	489800000-N	608400000-E	611700000-N	
												PATCHING EXISTING PAVEMENT (FULL DEPTH)	ADJUSTMENT OF MANHOLES	STEEL BEAM GR	GUARDRAIL END UNITS, TYPE TL-3	GUARDRAIL ANCHOR UNITS, TYPE B-83 ^ EA	REM EXT GRDRL	GENERIC PAVEMENT MARKING ITEM (POLYCARBONATE H-SHAPED MARKERS)	SEEDING & MULCHING	RESPONSE FOR EROSION CONTROL	
												TON	EA	LF	EACH	EA	LF	EA	ACR	EA	
2026CPT.01.03.10661	Northampton	1	NC-35 N / NC 35 HWY	FROM SR 1341 (DEBERRYS MILL RD.) TO SR 1337 (BRITTON RD.)	1	2	2WU	2.24	21	12.436	14.676	5		627.00	4.00	4.00	897.00	148.00			
TOTAL FOR MAP NO. 1								2.24					5		627.00	4.00	4.00	897.00	148.00		
2026CPT.01.03.10661	Northampton	2	NC-35 N / NC 35 HWY	FROM SR 1337 (BRITTON RD.) TO MILL ST	1	2	2WU	3.609	21	14.676	18.285	5						239.00			
TOTAL FOR MAP NO. 2								3.609					5					239.00			
TOTAL FOR PROJ NO. 2026CPT.01.03.10661								5.849					10		627.00	4.00	4.00	897.00	387.00		
2026CPT.01.03.20661	Northampton	3	SR-1109 / BRYANTOWN RD	FROM SR 1108 (CHAPEL HILL CHURCH RD.) TO US 258	2	2	2WU	4.44	20	0	4.44	23	3						4.3	1	
TOTAL FOR MAP NO. 3								4.44					23	3						4.3	1
2026CPT.01.03.20661	Northampton	4	SR-1113 / ASH TOWN RD	FROM SR 1109 (BRYANTOWN RD.) TO DEAD END	2	2	2WU	1.49	19	0	1.49	51							1.4	1	
TOTAL FOR MAP NO. 4								1.49					51							1.4	1
2026CPT.01.03.20661	Northampton	5	SR-1114 / ASH TOWN RD	FROM SR 1113 (ASH TOWN RD.) TO DEAD END	2	2	2WU	0.77	18	0	0.77	22							0.7	1	
TOTAL FOR MAP NO. 5								0.77					22						0.7	1	
2026CPT.01.03.20661	Northampton	6	SR-1504 / CREEKSVILLE RD	FROM SR 1501 (DUSTY HILL RD.) TO SR 1500 (ZION CHURCH RD.)	2	2	2WU	3.05	18	0	3.05	5		4.00					2.9	1	
TOTAL FOR MAP NO. 6								3.05					5		4.00				2.9	1	
2026CPT.01.03.20661	Northampton	7	SR-1522 / EAGLETOWN RD	FROM NC 305 TO US 258	2	2	2WU	3.471	17	0	3.471	44							3.4	1	
TOTAL FOR MAP NO. 7								3.471					44						3.4	1	
2026CPT.01.03.20661	Northampton	8	SR-1523 / JOE BROWN RD	FROM SR 1522-EAGLETOWN RD. TO US 258	2	2	2WU	0.872	19	0	0.872	5							0.8	1	
TOTAL FOR MAP NO. 8								0.872					5						0.8	1	
TOTAL FOR PROJ NO. 2026CPT.01.03.20661								14.093					150	3		4.00				13.6	6
GRAND TOTAL								19.942					160	3	627.00	8.00	4.00	897.00	387.00	13.6	6

PROJECT NO.	SHEET NO.	TOTAL NO.
2026CPT.01.03.10661, ETC.	6	

THERMOPLASTIC AND PAINT QUANTITIES

PROJECT NO	COUNTY	MAP NO	ROUTE	DESCRIPTION	TYP NO	LANES	LANE TYPE	LENGTH	WIDTH	BEGIN MP	END MP	0000100000-N	4413000000-E	4457000000-N	4688000000-E		4709000000-E	4720000000-E	4810000000-E									
												MOBILIZATION	WORK ZONE ADVANCE/GENERAL WARNING SIGNING	TEMPORARY TRAFFIC CONTROL (SP)	THERMOPLASTIC PAVEMENT MARKING LINES (6", 90 MILS) WHITE	THERMOPLASTIC PAVEMENT MARKING LINES (6", 90 MILS) YELLOW	THERMO PAVEMENT MARKING LINES (24" 90 MILS) (SP)	THERMOPLASTIC PAVEMENT MARKING CHARACTER (90 MILS), RXR	PAINT MARKING LINES (4") WHITE	PAINT MARKING LINES (4") YELLOW								
								MI	FT											LS	SF	LS	LF	LF	LF	EA	LF	LF
2026CPT.01.03.10661	Northampton	1	NC-35 N / NC 35 HWY	FROM SR 1341 (DEBERRYS MILL RD.) TO SR 1337 (BRITTON RD.)	1	2	2WU	2.24	21	12.436	14.676	1	86	1	23,654	14,784				23,654	14,784							
TOTAL FOR MAP NO. 1								2.24												*	86	*	23,654	14,784			23,654	14,784
2026CPT.01.03.10661	Northampton	2	NC-35 N / NC 35 HWY	FROM SR 1337 (BRITTON RD.) TO MILL ST	1	2	2WU	3.609	21	14.676	18.285	*	118	*	38,111	23,819	62	8		38,111	23,819							
TOTAL FOR MAP NO. 2								3.609												*	118	*	38,111	23,819	62	8	38,111	23,819
TOTAL FOR PROJ NO. 2026CPT.01.03.10661								5.849												*	204	*	61,765	38,603	62	8	61,765	38,603
												100,368						100,368										
2026CPT.01.03.20661	Northampton	3	SR-1109 / BRYANTOWN RD	FROM SR 1108 (CHAPEL HILL CHURCH RD.) TO US 258	2	2	2WU	4.44	20	0	4.44	*	190	*						46,886	29,304							
TOTAL FOR MAP NO. 3								4.44												*	190	*				46,886	29,304	
2026CPT.01.03.20661	Northampton	4	SR-1113 / ASH TOWN RD	FROM SR 1109 (BRYANTOWN RD.) TO DEAD END	2	2	2WU	1.49	19	0	1.49	*	64	*						15,734	9,834							
TOTAL FOR MAP NO. 4								1.49												*	64	*				15,734	9,834	
2026CPT.01.03.20661	Northampton	5	SR-1114 / ASH TOWN RD	FROM SR 1113 (ASH TOWN RD.) TO DEAD END	2	2	2WU	0.77	18	0	0.77	*		*						8,131	5,082							
TOTAL FOR MAP NO. 5								0.77												*		*				8,131	5,082	
2026CPT.01.03.20661	Northampton	6	SR-1504 / CREEKSVILLE RD	FROM SR 1501 (DUSTY HILL RD.) TO SR 1500 (ZION CHURCH RD.)	2	2	2WU	3.05	18	0	3.05	*	118	*						32,208	20,130							
TOTAL FOR MAP NO. 6								3.05												*	118	*				32,208	20,130	
2026CPT.01.03.20661	Northampton	7	SR-1522 / EAGLETOWN RD	FROM NC 305 TO US 258	2	2	2WU	3.471	17	0	3.471	*	158	*			48	8		36,654	22,909							
TOTAL FOR MAP NO. 7								3.471												*	158	*		48	8	36,654	22,909	
2026CPT.01.03.20661	Northampton	8	SR-1523 / JOE BROWN RD	FROM SR 1522-EAGLETOWN RD. TO US 258	2	2	2WU	0.872	19	0	0.872	*		*			48	8		9,208	5,755							
TOTAL FOR MAP NO. 8								0.872												*		*		48	8	9,208	5,755	
TOTAL FOR PROJ NO. 2026CPT.01.03.20661								14.093												*	530	*		96	16	148,821	93,014	
																		241,835										
GRAND TOTAL								19.942												1	734	1	61,765	38,603	158	24	210,586	131,617
												100,368						342,203										

THERMOPLASTIC AND PAINT QUANTITIES

PROJECT NO	COUNTY	MAP NO	ROUTE	DESCRIPTION	TYP NO	LANES	LANE TYPE	LENGTH	WIDTH	BEGIN MP	END MP	4830000000-E	4835000000-E	4840000000-N	4704000000-E	4890000000-E					
												PAINT PAVEMENT MARKING LINES (16")	PAINT PAVEMENT MARKING LINES (24")	PAINT PAVEMENT MARKING CHARACTER (MSG RXR)	THERMO LINE 16" 90 MILS (SP)	HOT SPRAY THERMOPLASTIC PAVEMENT MARKING LINES, (4", 65 MILS) WHITE	HOT SPRAY THERMOPLASTIC PAVEMENT MARKING LINES, (4", 65 MILS) YELLOW				
								MI	FT							LF	LF	EA	LF	LF	LF
2026CPT.01.03.10661	Northampton	1	NC-35 N / NC 35 HWY	FROM SR 1341 (DEBERRYS MILL RD.) TO SR 1337 (BRITTON RD.)	1	2	2WU	2.24	21	12.436	14.676										
TOTAL FOR MAP NO. 1								2.24													
2026CPT.01.03.10661	Northampton	2	NC-35 N / NC 35 HWY	FROM SR 1337 (BRITTON RD.) TO MILL ST	1	2	2WU	3.609	21	14.676	18.285	84	62	8	84						
TOTAL FOR MAP NO. 2								3.609								84	62	8	84		
TOTAL FOR PROJ NO. 2026CPT.01.03.10661								5.849								84	62	8	84		84
												84						84			
2026CPT.01.03.20661	Northampton	3	SR-1109 / BRYANTOWN RD	FROM SR 1108 (CHAPEL HILL CHURCH RD.) TO US 258	2	2	2WU	4.44	20	0	4.44					46,886	29,304				
TOTAL FOR MAP NO. 3								4.44										46,886	29,304		
2026CPT.01.03.20661	Northampton	4	SR-1113 / ASH TOWN RD	FROM SR 1109 (BRYANTOWN RD.) TO DEAD END	2	2	2WU	1.49	19	0	1.49					15,734	9,834				
TOTAL FOR MAP NO. 4								1.49										15,734	9,834		
2026CPT.01.03.20661	Northampton	5	SR-1114 / ASH TOWN RD	FROM SR 1113 (ASH TOWN RD.) TO DEAD END	2	2	2WU	0.77	18	0	0.77					8,131	5,082				
TOTAL FOR MAP NO. 5								0.77										8,131	5,082		
2026CPT.01.03.20661	Northampton	6	SR-1504 / CREEKSVILLE RD	FROM SR 1501 (DUSTY HILL RD.) TO SR 1500 (ZION CHURCH RD.)	2	2	2WU	3.05	18	0	3.05					32,208	20,130				
TOTAL FOR MAP NO. 6								3.05										32,208	20,130		
2026CPT.01.03.20661	Northampton	7	SR-1522 / EAGLETOWN RD	FROM NC 305 TO US 258	2	2	2WU	3.471	17	0	3.471	84	48	8	84	36,654	22,909				
TOTAL FOR MAP NO. 7								3.471								84	48	8	84	36,654	22,909
2026CPT.01.03.20661	Northampton	8	SR-1523 / JOE BROWN RD	FROM SR 1522-EAGLETOWN RD. TO US 258	2	2	2WU	0.872	19	0	0.872	84	48	8	84	9,208	5,755				
TOTAL FOR MAP NO. 8								0.872								84	48	8	84	9,208	5,755
TOTAL FOR PROJ NO. 2026CPT.01.03.20661								14.093								168	96	16	168	148,821	93,014
																		241,835			
GRAND TOTAL								19.942								252	158	24	252	148,821	93,014
												241,835						241,835			

NOTES: Less than 5' - 10' undisturbed buffer from ROW, ditchline, water feature, or drainage inlet, add BMP.

BMP Options: Wattle or Silt Fence

EROSION CONTROL DETAIL

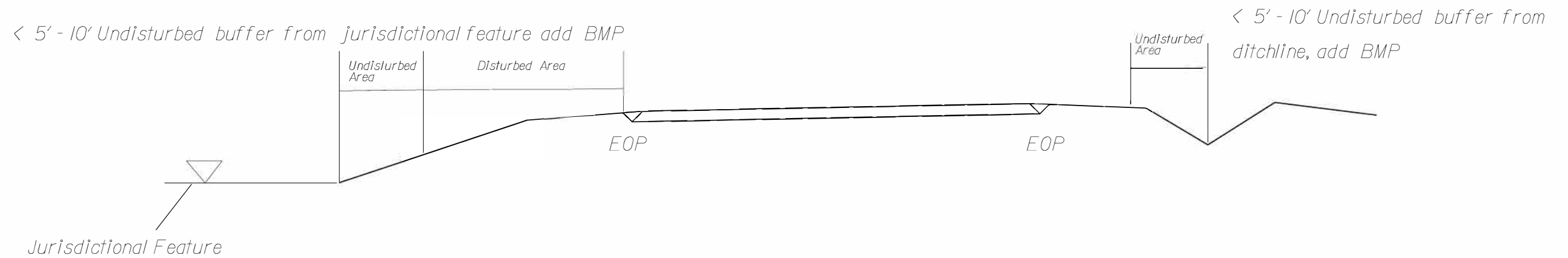
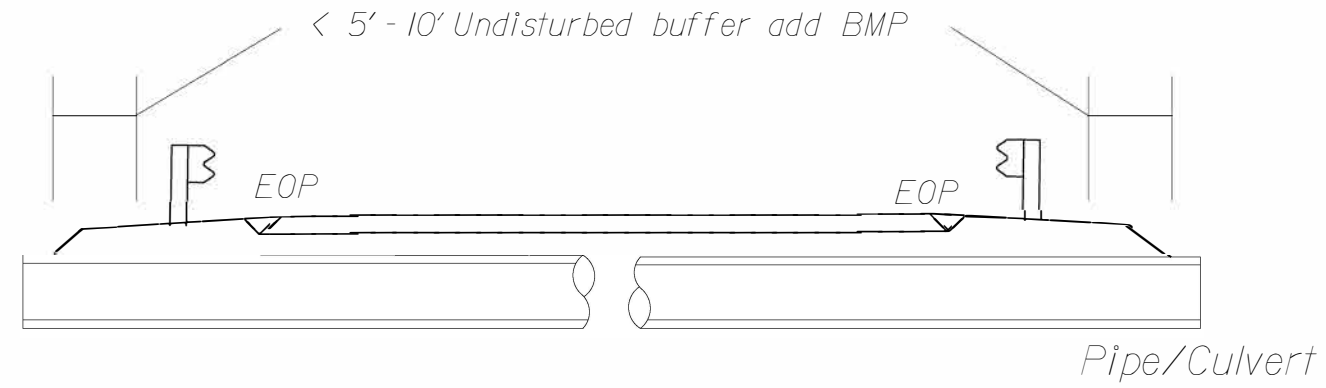

Use BMP's if shoulders and/or frontslopes and/or ditchline and/or backslopes are disturbed



< 5' - 10' Undisturbed buffer from inlet, add wattle

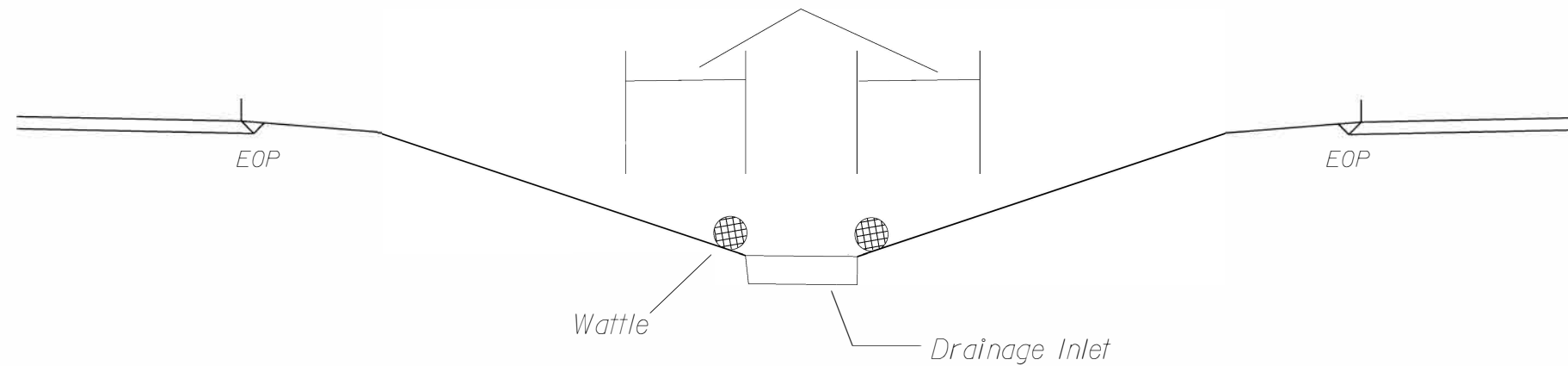

NOT TO SCALE

DIVISION OF HIGHWAYS
STATE OF NORTH CAROLINA

SOIL STABILIZATION TIMEFRAMES

SITE DESCRIPTION	STABILIZATION TIME	TIMEFRAME EXCEPTIONS
PERIMETER DIKES, SWALES, DITCHES AND SLOPES	7 DAYS	NONE
HIGH QUALITY WATER (HQW) ZONES	7 DAYS	NONE
SLOPES STEEPER THAN 3:1	7 DAYS	IF SLOPES ARE 10' OR LESS IN LENGTH AND ARE NOT STEEPER THAN 2:1, 14 DAYS ARE ALLOWED.
SLOPES 3:1 OR FLATTER	14 DAYS	7 DAYS FOR SLOPES GREATER THAN 50' IN LENGTH.
ALL OTHER AREAS WITH SLOPES FLATTER THAN 4:1	14 DAYS	NONE, EXCEPT FOR PERIMETERS AND HQW ZONES.

SIGNING FOR RESURFACING PROJECTS

LEGEND
 ┆ STATIONARY SIGN
 ← DIRECTION OF TRAFFIC FLOW

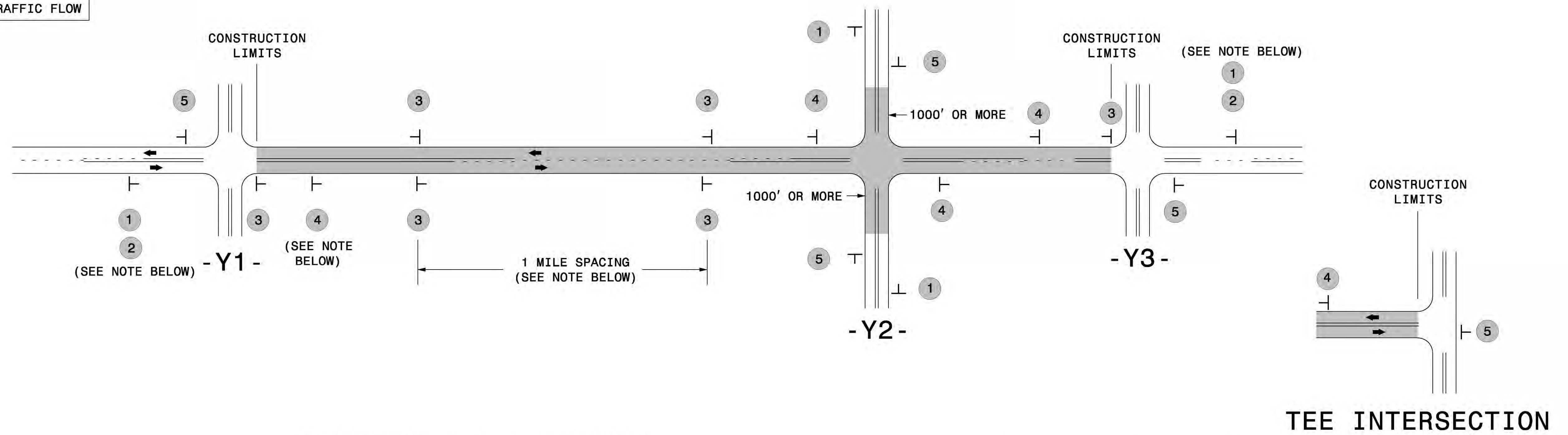

MAINLINE (-L-) SIGNING

-Y- LINE SIGNING

SIGNING NOTES AND PLACEMENT PER DIRECTION	1		PLACE 1000' PRIOR TO BEGINNING OF CONSTRUCTION LIMITS. ONLY USED ON -Y- LINES IF RESURFACING LIMITS EXTEND 1000' ALONG -Y- LINE.	<p>NO REQUIRED STATIONARY SIGNING FOR THE FOLLOWING -Y- LINE CONDITIONS:</p> <ol style="list-style-type: none"> LESS THAN 1000' OF RESURFACING ALONG -Y- LINE SUBDIVISION ROADS DEAD END ROADS <p>WHEN PAVING/CONSTRUCTION ACTIVITIES PROCEED ACROSS AN UNSIGNED -Y- LINE, PORTABLE ADVANCE WARNING SIGNS SHALL BE USED ALONG THE -Y- LINE AS SHOWN BELOW. REMOVE UPON COMPLETION OF WORK.</p> <div style="display: flex; justify-content: space-around;"> <div style="text-align: center;"> PLACED 500' IN ADVANCE OF FLAGGER. </div> <div style="text-align: center;"> PLACED 250' IN ADVANCE OF FLAGGER. </div> </div>
	2		#2 SIGN ONLY USED WHEN CONSTRUCTION LIMITS ARE 2 OR MORE MILES IN LENGTH. ROUND UP TO NEXT WHOLE NUMBER. (NO FRACTIONAL OR DECIMAL NUMBERS)	
	3		- PLACE INITIALLY AT THE CONSTRUCTION LIMITS AND SPACE 1 MILE APART THEREAFTER. - AT TEE INTERSECTIONS INSTALL INITIALLY 1/2 MILE FROM INTERSECTION AND SPACE 1 MILE APART THEREAFTER.	
	4		- THESE ARE FOR -Y- LINES THAT ARE "THROUGH" ROADWAYS. - DEAD END AND SUBDIVISION ROADS ARE NOT "THROUGH" ROADWAYS. - INSTALL 500' +/- FROM EACH -Y- LINE APPROACH AS SHOWN ABOVE. - FOR MULTIPLE -Y- LINES THAT ARE SEPARATED BY 0.25 MILES OR LESS, TREAT AS A SINGLE UNIT AND INSTALL WITHIN 500' OF EACH APPROACH. - A MAXIMUM OF 2 SIGN SETS PER MILE. DO NOT INSTALL WHEN -Y- LINES ARE WITHIN 0.5 MILES FROM "END ROAD WORK" SIGN. - FOR TEE INTERSECTIONS, INSTALL WITHIN 500' +/- OF THE INTERSECTION ALONG -L- LINE.	
	5		PLACE 500' FOLLOWING THE END OF CONSTRUCTION LIMITS OR AS SHOWN WHEN WORK ENDS AT A 3-WAY TEE INTERSECTION.	

THE ABOVE SIGNS ARE ALL THAT ARE REQUIRED FOR A CONTRACTOR TO BEGIN A RESURFACING CONTRACT. ANY ADDITIONAL SIGNS REQUESTED BY NCDOT DIVISIONS SHALL BE INSTALLED WITHIN 7 BUSINESS DAYS OF THE START OF CONTRACT WORK.

MAPS LESS THAN 2 MILES

FOR RESURFACING MAPS WITH CONSTRUCTION LIMITS LESS THAN 2 MILES IN LENGTH, NO STATIONARY SIGNS ARE REQUIRED. USE PORTABLE "ROAD UNDER CONSTRUCTION" OR "ROAD WORK AHEAD" SIGNS IN LIEU OF STATIONARY ADVANCE WARNINGS SIGNS.

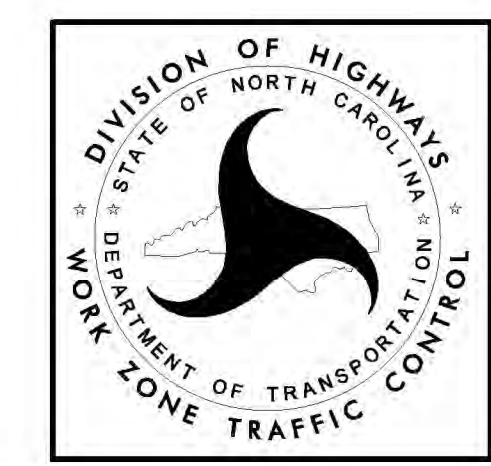

ADVANCE WARNING SIGNS FOR RURAL AND SUBURBAN 2-LANE ROADWAY RESURFACING

5/15/2017 5:11:10 PM \\NCDOT\resurfacing\2L2W & AST Resurfacing Details\Resurfacing_AdvWarn_2Ln.dgn User:keads